

## HONSBERG - VHS SERIES FLOW METER

### Spindle (screw)

VHS065GAO2500I

Flow sensor, 4-20mA, 25 - 2500l/min, G2.1/2"

- For oil and lubricating liquids up to 40,000 cSt
- For high flows up to 2500 l/min
- Up to 350 bar pressure
- Light and compact design



#### Product description

Model VHS is a screw flow sensor designed especially for applications with viscose media and high flows. Has high accuracy regardless of viscosity up to 40,000 cSt and maintains a low sound level under 50dB during operation. All mounting positions are possible and the direction of flow is independent of mounting position.

#### Specifications

<b>Accuracy</b>	± 1% of the measurement value (at 20 cSt)
<b>Connection</b>	Internal thread, G 2½ "
<b>Electrical Connection</b>	M12x1, 4-pole
<b>Flow Max l/min Double</b>	3800
<b>Flow Range Max</b>	2500
<b>Flow Range Min</b>	25
<b>Function</b>	Screw
<b>IP Class</b>	IP67
<b>Material of connection</b>	Aluminium
<b>Output</b>	4 (0) ... 20 mA alt. 0 (2) ... 10 V
<b>Power Consumption</b>	19
<b>Pressure drop</b>	About 3 bars at 100 cSt
<b>Pressure Range Max</b>	160
<b>Repeatability</b>	0.25

Temperature range of media from	-25
Temperature range of media to	80
Weight	42.7
Viscosity Max	40000
Voltage DC max	30
Voltage DC min	10

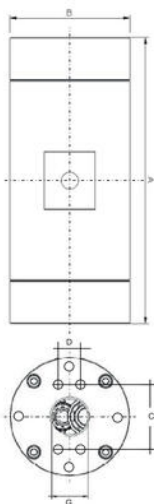

G"	A mm	B mm	C mm	D mm	X mm	Screw
1"	220	88	57.1	27.8	44	6xM8
1 1/4"	270	100	66.7	31.6	44	8xM8
1 1/2"	320	115	79.4	36.5	51	8xM10
1 3/4"	340	135	79.4	36.5	51	8xM12
2"	400	160	96.8	44.4	70	8xM14
2 1/4"	430	180	96.8	44.4	70	8xM16
2 1/2"	478	210	123.8	58.7	75	6xM20

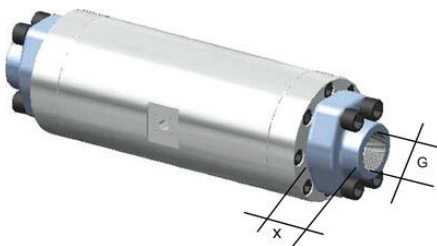

Push pull to PNP

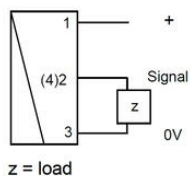

Push pull to NPN

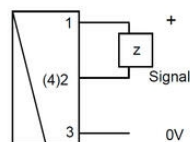

z = load

1 +10..30 V DC  
2 utsignal  
4 0 V

PNP/NPN (DIN 43650-A)

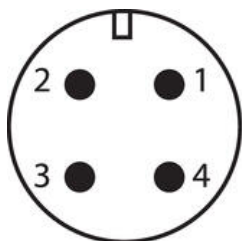

1 +10..30 V DC  
3 0 V  
4 utsignal

4-20 mA (M12x1-kontakt)



G"	A mm	B mm	C mm	D mm	X mm	Screw
1"	220	88	57.1	27.8	44	6xM8
1 1/4"	270	100	66.7	31.6	44	8xM8
1 1/2"	320	115	79.4	36.5	51	8xM10
1 3/4"	340	135	79.4	36.5	51	8xM12
2"	400	160	96.8	44.4	70	8xM14
2 1/4"	430	180	96.8	44.4	70	8xM16
2 1/2"	478	210	123.8	58.7	75	6xM20

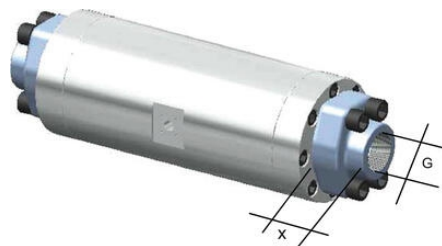

Push pull to PNP

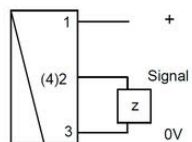

z = load

Push pull to NPN

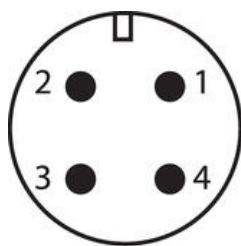
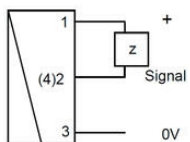

1 +10..30 V DC

2 utsignal

4 0 V

PNP/NPN (DIN 43650-A)

1 +10..30 V DC

3 0 V

4 utsignal

4-20 mA (M12x1-kontakt)