

HONSBERG - VHS SERIES FLOW METER

Spindle (screw)

VHS050GAO1500B

Flow sensor, PNP, 15 - 1500l/min, G2"

- For oil and lubricating liquids up to 40,000 cSt
- For high flows up to 2500 l/min
- Up to 350 bar pressure
- Light and compact design



Product description

Model VHS is a screw flow sensor designed especially for applications with viscose media and high flows. Has high accuracy regardless of viscosity up to 40,000 cSt and maintains a low sound level under 50dB during operation. All mounting positions are possible and the direction of flow is independent of mounting position.

Specifications

Accuracy	± 1% of the measurement value (at 20 cSt)
Connection	Internal thread, G 2 "
Electrical Connection	Plug connector DIN 43650-A
Flow Max l/min Double	2200
Flow Range Max	1500
Flow Range Min	15
Function	Screw
IP Class	IP67
Material of connection	Aluminium
Output	PNP / NPN frequency
Power Consumption	19
Pressure drop	About 3 bars at 100 cSt
Pressure Range Max	160
Repeatability	0.25

Temperature range of media from	-25
Temperature range of media to	80
Weight	25
Viscosity Max	40000
Voltage DC max	30
Voltage DC min	10

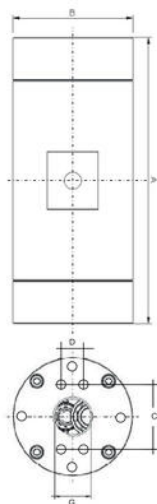

G"	A mm	B mm	C mm	D mm	X mm	Screw
1"	220	88	57.1	27.8	44	6xM8
1 1/4"	270	100	66.7	31.6	44	8xM8
1 1/2"	320	115	79.4	36.5	51	8xM10
1 3/4"	340	135	79.4	36.5	51	8xM12
2"	400	160	96.8	44.4	70	8xM14
2 1/4"	430	180	96.8	44.4	70	8xM16
2 1/2"	478	210	123.8	58.7	75	6xM20

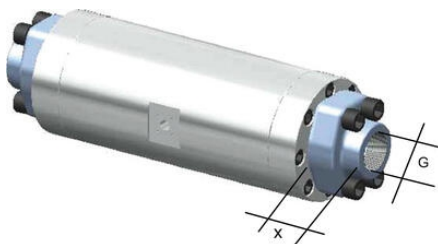

Push pull to PNP

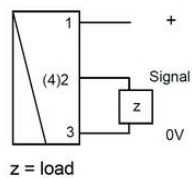

z = load

Push pull to NPN

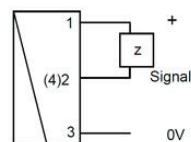

1 +10..30 V DC
2 utsignal
4 0 V

PNP/NPN (DIN 43650-A)

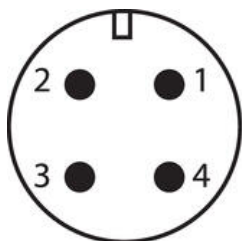

1 +10..30 V DC
3 0 V
4 utsignal

4-20 mA (M12x1-kontakt)



G"	A mm	B mm	C mm	D mm	X mm	Screw
1"	220	88	57.1	27.8	44	6xM8
1 1/4"	270	100	66.7	31.6	44	8xM8
1 1/2"	320	115	79.4	36.5	51	8xM10
1 3/4"	340	135	79.4	36.5	51	8xM12
2"	400	160	96.8	44.4	70	8xM14
2 1/4"	430	180	96.8	44.4	70	8xM16
2 1/2"	478	210	123.8	58.7	75	6xM20

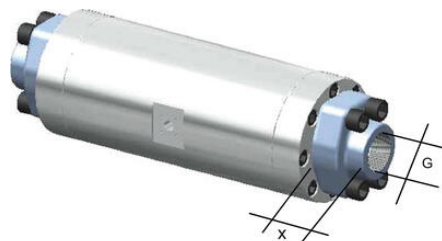

Push pull to PNP

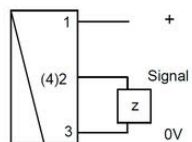

z = load

Push pull to NPN

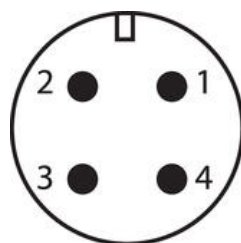
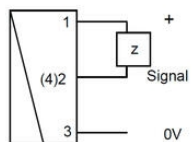

1 +10..30 V DC

2 utsignal

4 0V

PNP/NPN (DIN 43650-A)

1 +10..30 V DC

3 0V

4 utsignal

4-20 mA (M12x1-kontakt)