

VALCO - CV SERIES FLOW INDICATOR

Sight glass/rotor

00.0006.0057.1

0,6..10 l/min H2O, G1/4F, Brass

- Ranges covering 0.6..80 l/min H2O
- Bidirectional
- Up to 25 bar max (depending on model)
- Brass connections



PRODUCT DESCRIPTION

The CV series flow indicator from Val.Co allows a visual inspection of the passage of liquids in hydraulic and water systems. The propeller is coloured for better visualization with opaque liquids and there is also an option for a blue propeller and an output.

SPECIFICATIONS

Colour of rotor	Red
Flow Range Max	10
Manufacturer Part No	CV.008G.PSO.R
Max. pressure	25
Min flow rate for rotor (oil 40 Cst) l/min	2.5
Min flow rate for rotor (oil 41-150 Cst) l/min	3.5
Min flow rate for rotor (water) l/min	0.6
Pressure Drop	0.15
Temperature range to	100

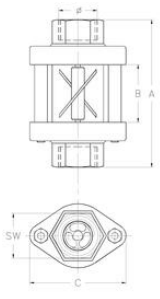

G"	Model	A mm	B mm	C mm	SW mm	Weight kg
1/4	CV-008	66	22	44	20	0,10
3/8	CV-010	92	36	60	28	0,17
1/2	CV-015	92	36	60	28	0,17
3/4	CV-020	114	46	70	46	0,70
1	CV-025	114	46	70	46	0,60

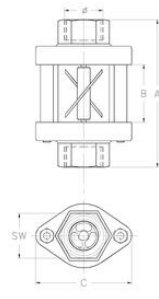
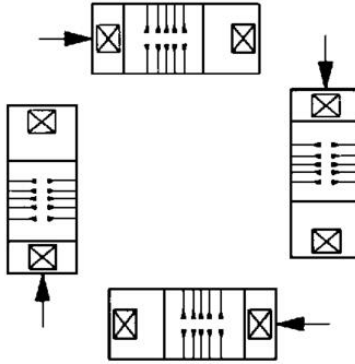
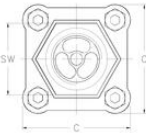

G"	Model	A mm	B mm	C mm	SW mm	Weight kg
1/4	CV-008	66	22	44	20	0,10
3/8	CV-010	92	36	60	28	0,17
1/2	CV-015	92	36	60	28	0,17
3/4	CV-020	114	46	70	46	0,70
1	CV-025	114	46	70	46	0,60

