

## JUNG HYGHSPIN EXTENDED SERIES PUMP

Hygienic twin screw pump

JPS HYGHSPIN 90E

- Flow 100l/h to 350m³/h
- Pressure up to 6 bar
- Viscosity up to 1,000,000 cSt
- Temperature -10°C to +130°C (180°C)
- Max. particle size 67mm



### Product description

The HYGHSPIN Extended is a variant of the worldwide tried and tested HYGHSPIN pump series made of high-quality stainless steel. The special focus for the HYGHSPIN Extended is on applications in the low-pressure range of up to 6 bar differential pressure.

The feed screws and the pump housing are extended. The HYGHSPIN Extended therefore expands the application possibilities for the individual sizes for higher volume flow rates or very large solids.

The HYGHSPIN Extended stands for high performance with compact dimensions. It is available in block design or with free shaft end.

### Specifications

<b>Connection</b>	Different sizes and connector standards by arrangement
<b>Differential Pressure</b>	6 bar
<b>Flow max m³/h Double</b>	100
<b>Material of elastomers</b>	EPDM, FPM, HNBR (Nitrile rubber), FFPM
<b>Materials Wetted Parts</b>	Stainless steel 316/316L (1.4401/1.4404), Stainless steel 1.4462, 1.4404, Stainless Steel 1.4539
<b>Maximum diameter of solid material</b>	45
<b>Pump orientation</b>	Horizontal, vertical or lateral
<b>Temperature range from</b>	-10
<b>Temperature range to</b>	180
<b>Viscosity</b>	0.5 - 1,000,000 mPas

Mått HYQHSPN Extended kompaktmonterad (mm)

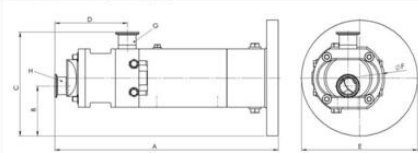

Pumpstorlek	A	B	C	D	E	F	G (radiell)	H (Axialt)	Vikt (kg)
Hyghapin 70E	690	200	295	249	300	199	DN40-DN80 (1,5"-3")	DN40-DN100 (1,5"-4")	66
Hyghapin 90E	850	140	334	340	300	259	DN60-DN100 (2"-4")	DN60-DN125 (2"-5")	150

Mått HYQHSPN Extended fl axial (mm)

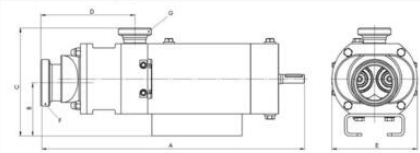

Pumpstorlek	A	B	C	D	E	F	G (Radiell)	H (Axialt)	Vikt (kg)
Hyghapin 70E	655	124	252	249	199		DN40-DN80 (1,5"-3")	DN40-DN100 (1,5"-4")	65
Hyghapin 90E	798	140	342	340	259		DN60-DN100 (2"-4")	DN60-DN125 (2"-5")	128
Hyghapin 120E	1094	212	491	370	249		DN65-DN150 (2,5"-6")	DN60-DN150 (3"-6")	365

Mått HYQHSPN Extended kompaktmonterad (mm)

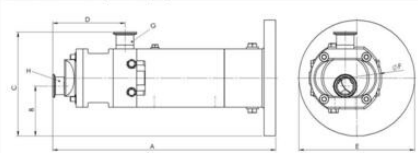

Pumpstorlek	A	B	C	D	E	F	G (radiell)	H (Axialt)	Vikt (kg)
Hyghapin 70E	690	200	295	249	300	199	DN40-DN80 (1,5"-3")	DN40-DN100 (1,5"-4")	66
Hyghapin 90E	850	140	334	340	300	259	DN60-DN100 (2"-4")	DN60-DN125 (2"-5")	150

Mått HYQHSPN Extended fl axial (mm)

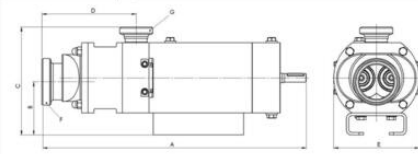

Pumpstorlek	A	B	C	D	E	F	G (Radiell)	H (Axialt)	Vikt (kg)
Hyghapin 70E	655	124	252	249	199		DN40-DN80 (1,5"-3")	DN40-DN100 (1,5"-4")	65
Hyghapin 90E	798	140	342	340	259		DN60-DN100 (2"-4")	DN60-DN125 (2"-5")	128
Hyghapin 120E	1094	212	491	370	249		DN65-DN150 (2,5"-6")	DN60-DN150 (3"-6")	365