

KDS-SR FRAMES & INLAYS

KDS-SR

28500.4
KDS-SR 6/10 BK - Screw Frame

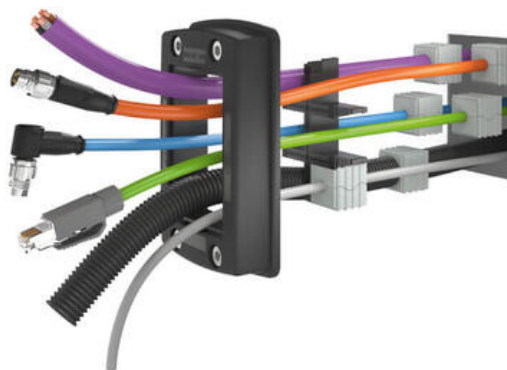

- Three parts, many solutions
- Reduced installation time
- Easy assembly from the inside to the outside
- Perfect for pre-assembled cables
- High IP66 protection

PRODUCT DESCRIPTION

Inlays can be clicked in to achieve the required size for the frame openings. This mechanism enables different frame configurations to be constructed for various cabling requirements and reducing the amount of items that need to be stocked. KDS screw frame The KDS-SR screw frames can be mounted directly onto the standard electrical-cabinet cut-outs for 4 to 24-pole industrial connectors. After the assembly, assembled cables can easily be fed through the frame from the inside of the cabinet. The optional inner KDS-IVR locking frame may then be used. It is secured using the four fastening screws on the screw-in frame. After the wires or cables have been fed in, the KDS-DE thermoplastic sealing sleeves provide an excellent seal (IP66) and also a mechanical strain relief mechanism for the cables. With a selection of 90 different sealing sleeves, perfect solutions can be designed for wire diameters from 2 to 33 mm. Inserts that will take 2 or 4 cables are available along with special inserts are available for Asi cables. For flat cables, the KDS-FP system has a wide range of inserts in a smaller frame size. The material used contains no halogen or silicon. It is also resistant to fuels, oils and greases. The grey seal sleeves are resistant to acids and alkalis. They are self-extinguishing in accordance with UL 94 V-0. The black sealing sleeves are suitable for applications with frequent temperature fluctuations because they feature long-term stability and UV stabilization.

SPECIFICATIONS

Approvals	cUL, UL
Color	Black
Country of origin	DE
cUL test standard	C22.2 No. 14-18
Diameter of the screw holes	5.5
Fixing screws	M5
Flamklass	V-0
Glass-fibre reinforced	Yes
Halogen free	Yes
Height	19.6
Installed height	19.6
IP Class	IP66
Length	106
Length of cutout	68.5
NEMA class	4x

Number of screw holes	4
Operating temperature from	-40
Operating temperature to	120
Pack Size	1
Silicone-free	Yes
Tariff code	39259020
UL test standard	UL 508A
Weight	75
Width	70

THE OVERWHELMING BENEFITS OF KDSCLICK!

KDS
CLICK

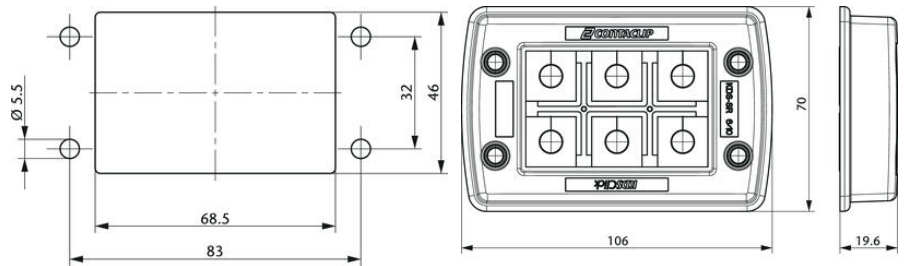

Torque for the frame's mounting screw: 2.5 – 3 Nm



THE OVERWHELMING BENEFITS OF KDSCLICK!

KDS
CLICK

