

DATALOGIC POWERSCAN PM9501

PM9501-HP910RBK20

PowerScan PM9501, HP/LL, RS-232 Remov Batt Kit
(Base, Cable, Power Brick & Cord)

- Detects 1D and 2D code types
- Reads up to 4mil/2.5mil 1D codes and 7.5 mil/4mil 2D codes
- 60,000+ reads per charge
- Interfaces: RS-232, Keyboard Wedge, USB and Ethernet



Product description

The PowerScan PM9500 area imager is a ruggedized cordless reader suitable for all demanding applications. It is equipped with a new generation of Datalogic's STAR Cordless System, a proprietary radio which further improves the outstanding features of versatility, ease-of-use and radio range.

The PM9500 series offers two display options: 4 configurable keys and a full 16-key keyboard. This increases interaction between the host and the user allowing a two-way exchange of information for more reliable and effective communications.

Long lasting battery life guarantees more than one shift of intensive scanning.

The handle shape, well-balanced weight and an intuitive aiming system allow high first-pass reading rates while reducing unnatural wrist movements for improved ergonomics and user comfort. The PowerScan 9500 area imagers use a soft-pulsed white illumination light that is very gentle on the eyes and less troublesome to the operator during scan-intensive applications.

The BC9180 base/charger also includes in one model two different Ethernet connections: Standard Ethernet and Industrial Ethernet protocols such as Ethernet IP and Modbus.

Specifications

1D Code types	Auto discriminates all standard 1D codes
2D Code Types	Aztec Code, China Han Xin Code, Data Matrix, MaxiCode, Micro QR Code, QR Code
Approvals	RoHS
Battery	Lithium-Ion: 3350 mAh
Charge time	4.5hrs @ 10-30 VDC
Color	Black/yellow
Dimension (mm)	212 x 110 x 74
Drop resistance	Withstands 50 drops from 1.2m / 6.6ft onto a concrete surface

Humidity	0-95% (Non-condensing)
Immunity To Ambient Light	0-100,000 lux
Interface	RS-232
IP Class	IP65
Kit	Yes
Light Source	630-680nm VLD
Postal Code Types	China Post, IMB, KIX Post, Planet Code, Postnet, Royal Mail Code (RM4SCC), Australia Postal, Japan Postal, Portuguese Post, Swedish Post
Readable code types	1D / Linear Codes, 2D Codes, Postal Codes, Stacked Codes
Reading Angle Window	Pitch: +/-40°; Roll (Tilt): 360°; Skew (Yaw): +/-40°
Reads per charge	60000
Resolution	7.5mils
Stacked Code Types	EAN/JAN Composites, GS1 Databar Composites, GS1 Databar Expanded Stacked, GS1 Databar Stacked, GS1 Databar Stacked Omnidirectional, Macro PDF, Micro PDF 417, PDF 417, UPC A/E Composites
Temperature range bearing, from	-40
Temperature range bearing, to	70
Temperature range from	-20
Temperature range to	50
Weight	445
Wireless	Yes
Wireless Technology	Effective radiated power

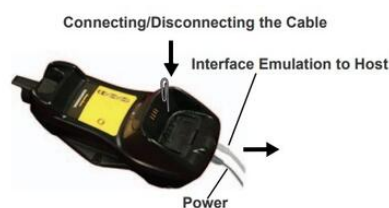

RS-232



*The power supply is optional, the cradle can be powered by the USB port. In this case the full charging of an empty battery will take about 10 hours. For intense usage and/or when the system is shut down during the night, the use of an external power supply is recommended.

WEDGE

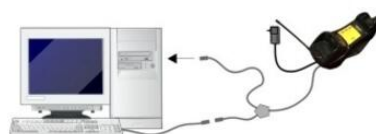

Connecting/Disconnecting the Cable

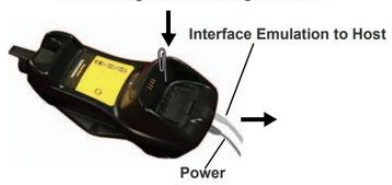

RS-232



USB*



*The power supply is optional, the cradle can be powered by the USB port. In this case the full charging of an empty battery will take about 10 hours. For intense usage and/or when the system is shut down during the night, the use of an external power supply is recommended.

WEDGE

