

KUEBLER - MAGNET SENSOR LI50 WITH MAGNETIC TAPE B2

SERIE 8.LI50

- Resolution up to 0.005 mm
- Contactless measuring technology
- Status LED
- IP67 Impervious to chips, oil, water, etc.



PRODUCT DESCRIPTION

Linear sensor used to measure linear movements with high accuracy, for example in woodworking machines, lathes, material handling, overhead cranes etc. The sensor is almost entirely non-sensitive to chips, oil, dust and water and can thus be used in troublesome environments, it is sealed and has no moving parts. This sensor is fitted to read a magnetic tape with a self-adhesive underside. This sensor is available with different resolutions, and if the recipient (counter/PLC) has a multiplication function, a resolution of 5 μm can be achieved. See electrical data (Resolution, Accuracy) for more information. Magnetic tape B2 has a polar distance of 5 mm. For the combination LI50/B2, the distance between sensor and tape must be 0.1 to 2.0 mm (1.0 mm is recommended). For the magnet sensor, the slope must not exceed $\pm 3^\circ$, the rotation must not exceed $\pm 3^\circ$ and the offset must not exceed ± 1 mm.

The following information is required to select the right combination:

- requirement on accuracy (from 0.1 mm to 0.005 mm)
- the movement's speed (taking into account frequency to subsequent systems and the sensor's max. speed)
- the movement's length (to order the magnetic scale's length = required length of measurement + 1 dm)

Please refer to the images below for ordering information.

Order code sensor head Limes LI50		8.LI50 . X1X1 . 2XXX						
		Type	a	b	c	d	e	f
a Model	1 = IP67, standard 2 = IP68 / IP69k and humidity tested acc. to EN 60068-3-38, EN 60068-3-78	c Output circuit / power supply	1 = RS422 / 4.8 ... 26 V DC 2 = Push-pull / 4.8 ... 30 V DC		e Reference signal	2 = index periodic		Stock types
b Pulse edge interval	1 = standard	d Type of connection	1 = cable, 2 m [6.56'] PUR		f Code (resolution) ¹⁾	050 = 25 μm 250 = 5 μm		8.LI50.1111.2050 8.LI50.1111.2250 8.LI50.1121.2050 8.LI50.1121.2250

Order code magnetic band Limes B2		8.B2 . 10 . 010 . XXXX						
		Type	a	b				
a Width	10 = 10 mm	b Length	0010 = 1 m 0020 = 2 m 0040 = 4 m 0050 = 5 m	0060 = 6 m 0100 = 10 m 0200 = 20 m	Optional on request	- other lengths up to 70 m		Stock types
								8.B2.10.010.0020

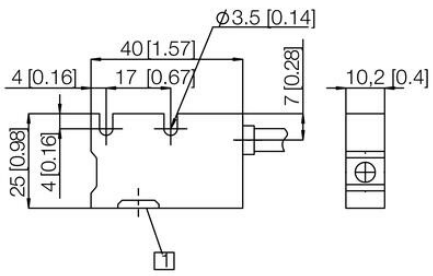

1 mätområde

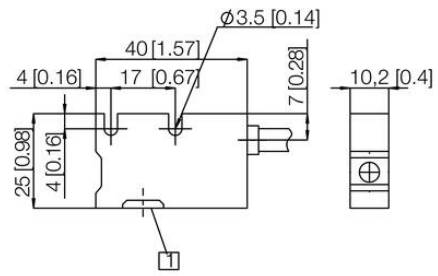

1 mätområde