



KUEBLER - ABSOLUTE-CODED ANGULAR TRANSMITTER SENDIX M3668R, MAGNETIC, CANOPEN, Ø36 MM

SERIE M3668R SS

- Housing diameter Ø36 mm
- CANopen
- Up to IP69K
- Stainless steel



Product description

Sendix M3668R is a magnetically encoded absolute encoder with the latest in multi-field technology with "Energy Harvesting". Energy Harvesting technology is based on magnetic recharging, eliminating both battery and gear.

In addition to multi-color technology, the M3668R has been equipped with extra strong ball bearings and secure attachments, also known as "Safety-Lockplus™".

A unique multifarve pulse sensor with high IP classifications: IP66, IP67 and IP69K, available in stainless steel (V4A).

Please refer to the image below for ordering information.

Order code		8.M3668R.XX2X.2122									
Shaft version		Type	a	b	c	d	e				
a	Version	c Interface / power supply									
1 = standard ¹⁾		2 = CANopen DS301 V4.2 / 10 ... 30 V DC									
clamping flange ø 42 mm [1.65"]		d Type of connection									
7 = stainless steel V4A ²⁾											
clamping flange ø 42 mm [1.65"]		2 = radial cable, 1 m [3.28'] PVC									
all metal parts accessible from outside		B = radial cable, special length PVC *)									
are out of stainless steel V4A		4 = radial M12 connector, 5-pin									
b	Shaft (ø x L), with flat	*) Available special lengths (connection type B):									
1 = ø 6 x 12.5 mm [0.24 x 0.49"]		2, 3, 5, 8, 10, 15 m [5.56, 9.84, 16.40, 26.25, 32.80, 49.21']									
3 = ø 8 x 15 mm [0.32 x 0.59"]		order code expansion .XXXX = length in dm									
5 = ø 10 x 20 mm [0.39 x 0.79"]		ex.: 8.M3668.132B.2122.0030 (for cable length 3 m)									
2 = ø 1/4" x 12.5 mm [0.49"]											
E = ø 10 x 20 mm [0.39 x 0.79"],											
stainless steel V4A											
		e Fieldbus profile									
		21 = CANopen									
		Optional on request									
		- Ex 2/22 (only for connection type 4)									
		- other shaft diameters out of V4A									
		stainless steel									

Specifications

Connection Thread	M12
Housing diameter	36
IP Class	IP66, IP67, IP69K
Mounting	Shoulder
Output	CANopen
Resolution More Yards	Max. 24 bit
Sensor type	Absolute

Shaft Diameter max	10
Shaft Diameter min	10
Supply Voltage DC Max	30
Supply Voltage DC Min	10
Temperature range from	-40
Temperature range to	85
Version	Multiturn

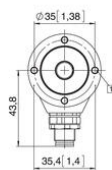
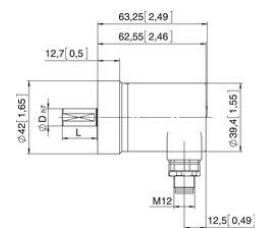

Interface	Type of connector	Cable (Isolate unused wires individually before initial start-up)
2	2, 8	Signal: +V, 0V, CAN_GND, CAN_H, CAN_L Cable colour: BRN, WHI, GT, GRN, VIO
Interface	Type of connector	M12 connector, 5-pin
2	4	Signal: +V, 0V, CAN_GND, CAN_H, CAN_L Pin: 2, 3, 1, 4, 5



Interface	Type of connector	Cable (Isolate unused wires individually before initial start-up)
2	2, 8	Signal: +V, 0V, CAN_GND, CAN_H, CAN_L Cable colour: BRN, WHI, GT, GRN, VIO
Interface	Type of connector	M12 connector, 5-pin
2	4	Signal: +V, 0V, CAN_GND, CAN_H, CAN_L Pin: 2, 3, 1, 4, 5

