



**KUEBLER - ABSOLUTE-CODED  
ANGULAR TRANSMITTER SENDIX  
M3668R, MAGNETIC, CANOPEN, Ø36 MM**  
SERIE M3668R



- Housing diameter Ø36 mm
- CANopen
- Up to IP69K
- Stainless steel

**PRODUCT DESCRIPTION**

Sendix M3668R is a magnetically encoded absolute encoder with the latest in multi-field technology with "Energy Harvesting". Energy Harvesting technology is based on magnetic recharging, eliminating both battery and gear.

In addition to multi-color technology, the M3668R has been equipped with extra strong ball bearings and secure attachments, also known as "Safety-Lockplus™".

A unique multifarve pulse sensor with high IP classifications: IP66, IP67 and IP69K, available in stainless steel (V4A).

Please refer to the image below for ordering information.

<b>Order code</b>	<b>8.M3668R.XX2X.2122</b>					
<b>Shaft version</b>	Type	a	b	c	d	e
<b>a</b> Version		<b>c</b> Interface / power supply			<b>e</b> Fieldbus profile	
<b>1 = standard</b> <sup>1)</sup>		<b>2 = CANopen DS301 V4.2 / 10 ... 30 V DC</b>			<b>21 = CANopen</b>	
<b>clamping flange ø 42 mm [1.65"]</b>		<b>d</b> Type of connection			Optional on request	
7 = stainless steel V4A <sup>2)</sup>		2 = radial cable, 1 m [3.28"] PVC			- Ex 2/22 (only for connection type 4)	
clamping flange ø 42 mm [1.65"]		B = radial cable, special length PVC *)			- other shaft diameters out of V4A	
all metal parts accessible from outside		<b>4 = radial M12 connector, 5-pin</b>			stainless steel	
are out of stainless steel V4A		*) Available special lengths (connection type B):				
<b>b</b> Shaft (ø x L), with flat		2, 3, 5, 8, 10, 15 m [5.56, 9.84, 16.40, 26.25, 32.80, 49.21']				
1 = ø 6 x 12.5 mm [0.24 x 0.49"]		order code expansion .XXXX = length in dm				
<b>3 = ø 8 x 15 mm [0.32 x 0.59"]</b>		ex.: 8.M3668.132B.2122.0030 (for cable length 3 m)				
5 = ø 10 x 20 mm [0.39 x 0.79"]						
2 = ø 1/4" x 12.5 mm [0.49"]						
E = ø 10 x 20 mm [0.39 x 0.79"],						
stainless steel V4A						

**SPECIFICATIONS**

Housing diameter	36
IP Class	IP66, IP67, IP69K
Resolution More Yards	Max. 24 bit
Shaft Diameter max	10
Shaft Diameter min	6
Supply Voltage DC Max	30

Supply Voltage DC Min	10
Temperature range from	-40
Temperature range to	85

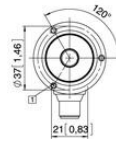
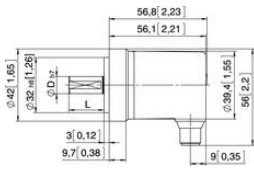

Interface	Type of connector	Cable (isolate unsheathed wires individually before initial start-up)
2	2.B	Signal: +V, 0V, CAN_GND, CAN_H, CAN_L Cable colour: BK, WH, GT, GR, YE
Interface	Type of connector	M12 connector, 5 pin
2	4	Signal: +V, 0V, CAN_GND, CAN_H, CAN_L Pin: 2, 3, 1, 4, 5

Top view of mating side, male contact base



M12 connector, 5-pin

Interface	Type of connector	Cable (isolate unsheathed wires individually before initial start-up)
2	2.B	Signal: +V, 0V, CAN_GND, CAN_H, CAN_L Cable colour: BK, WH, GT, GR, YE
Interface	Type of connector	M12 connector, 5 pin
2	4	Signal: +V, 0V, CAN_GND, CAN_H, CAN_L Pin: 2, 3, 1, 4, 5

Top view of mating side, male contact base



M12 connector, 5-pin