



KUEBLER - ABSOLUTE-CODED ANGULAR TRANSMITTER SENDIX M3663R, MAGNETIC, SSI, Ø36 MM SERIE M3663R

- Housing diameter Ø36 mm
- SSI
- Up to IP69K
- Stainless steel



Product description

Sendix M3663R is a magnetically encoded absolute encoder with the latest in multi-color technology with "Energy Harvesting". Energy Harvesting technology is based on magnetic recharging, eliminating both battery and gear.

In addition to multi-color technology, the M3663R has been equipped with extra strong ball bearings and secure attachments, also known as "Safety-Lockplus™".

A unique multifarve pulse sensor with high IP classifications: IP66, IP67 and IP69K, available in stainless steel (V4A).

Please refer to the image below for ordering information.

Order code	8.M3663R	.XX2X.XXX2	
Shaft version	Type	a b c d e f g	
a Version 1 = standard ¹⁾ clamping flange ø 42 mm [1.65"] 7 = stainless steel V4A ²⁾ clamping flange ø 42 mm [1.65"] all metal parts accessible from outside are out of stainless steel V4A	c Interface / power supply 2 = SSI / 10 ... 30 V DC	d Type of connection 2 = radial cable, 1 m [3.28'] PUR B = radial cable, special length PUR *) 4 = radial M12 connector, 8-pin *) Available special lengths (connection type B): 2, 3, 5, 8, 10, 15 m [5.56, 9.84, 16.40, 26.25, 32.80, 49.21'] order code expansion .XXXX = length in dm ex.: 8.M3663R.132B.G322.0030 (for cable length 3 m)	i Resolution (singleturn) A = 10 bit ST 2 = 12 bit ST 3 = 13 bit ST 4 = 14 bit ST
b Shaft (ø x L), with flat 1 = ø 6 x 12.5 mm [0.24 x 0.49"] 3 = ø 8 x 15 mm [0.32 x 0.59"] 5 = ø 10 x 20 mm [0.39 x 0.79"] 2 = ø 1/4" x 12.5 mm [0.49"] E = ø 10 x 20 mm [0.39 x 0.79"], stainless steel V4A	e Code B = SSI, binary G = SSI, gray	g Resolution (multiturn) 2 = 12 bit MT 6 = 16 bit MT A = 20 bit MT 4 = 24 bit MT Optional on request - Ex 2/22 (only for connection type 4) - other shaft diameters out of V4A stainless steel	

Specifications

Connection Thread	Cable, M12
Housing diameter	36
IP Class	IP66, IP67, IP69K
Mounting	Shoulder

Output	SSI
Resolution Envarv	10-14 bit
Resolution More Yards	Max. 24 bit
Sensor type	Absolute
Shaft Diameter max	10
Shaft Diameter min	6
Supply Voltage DC Max	30
Supply Voltage DC Min	10
Temperature range from	-40
Temperature range to	85
Version	Multiturn

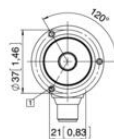
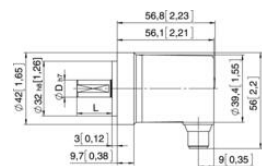

Interface	Type of connection	Features	Cable (isolate unused wires individually before initial start-up)
2	2,8	SET, DIR	Signal: 0V +V C+ C- D+ D- SET DIR H Cable colour: WH BN GN YE CY PK BU RD shield
Interface	Type of connection	Features	M12 connector, 8 pin
2	4	SET, DIR	Signal: 0V +V C+ C- D+ D- SET DIR H Pin: 1 2 3 4 5 6 7 8 Pin

+V Encoder power supply +V DC
 0V Encoder power supply ground (GND (0 V))
 C+ C- Clock signal
 D+ D- Data signal
 SET Set input. The current position becomes defined as position zero.
 DIR Direction input. If this input is active, output values are counted backwards (decrease) when the shaft is turning clockwise.
 Pin Plug connector housing (shield)

Top view of mating side, male contact base



M12 connector, 8 pin

Interface	Type of connection	Features	Cable (isolate unused wires individually before initial start-up)
2	2,8	SET, DIR	Signal: 0V +V C+ C- D+ D- SET DIR H Cable colour: WH BN GN YE CY PK BU RD shield
Interface	Type of connection	Features	M12 connector, 8 pin
2	4	SET, DIR	Signal: 0V +V C+ C- D+ D- SET DIR H Pin: 1 2 3 4 5 6 7 8 Pin

+V Encoder power supply +V DC
 0V Encoder power supply ground (GND (0 V))
 C+ C- Clock signal
 D+ D- Data signal
 SET Set input. The current position becomes defined as position zero.
 DIR Direction input. If this input is active, output values are counted backwards (decrease) when the shaft is turning clockwise.
 Pin Plug connector housing (shield)

Top view of mating side, male contact base



M12 connector, 8 pin